

US EPA ARCHIVE DOCUMENT

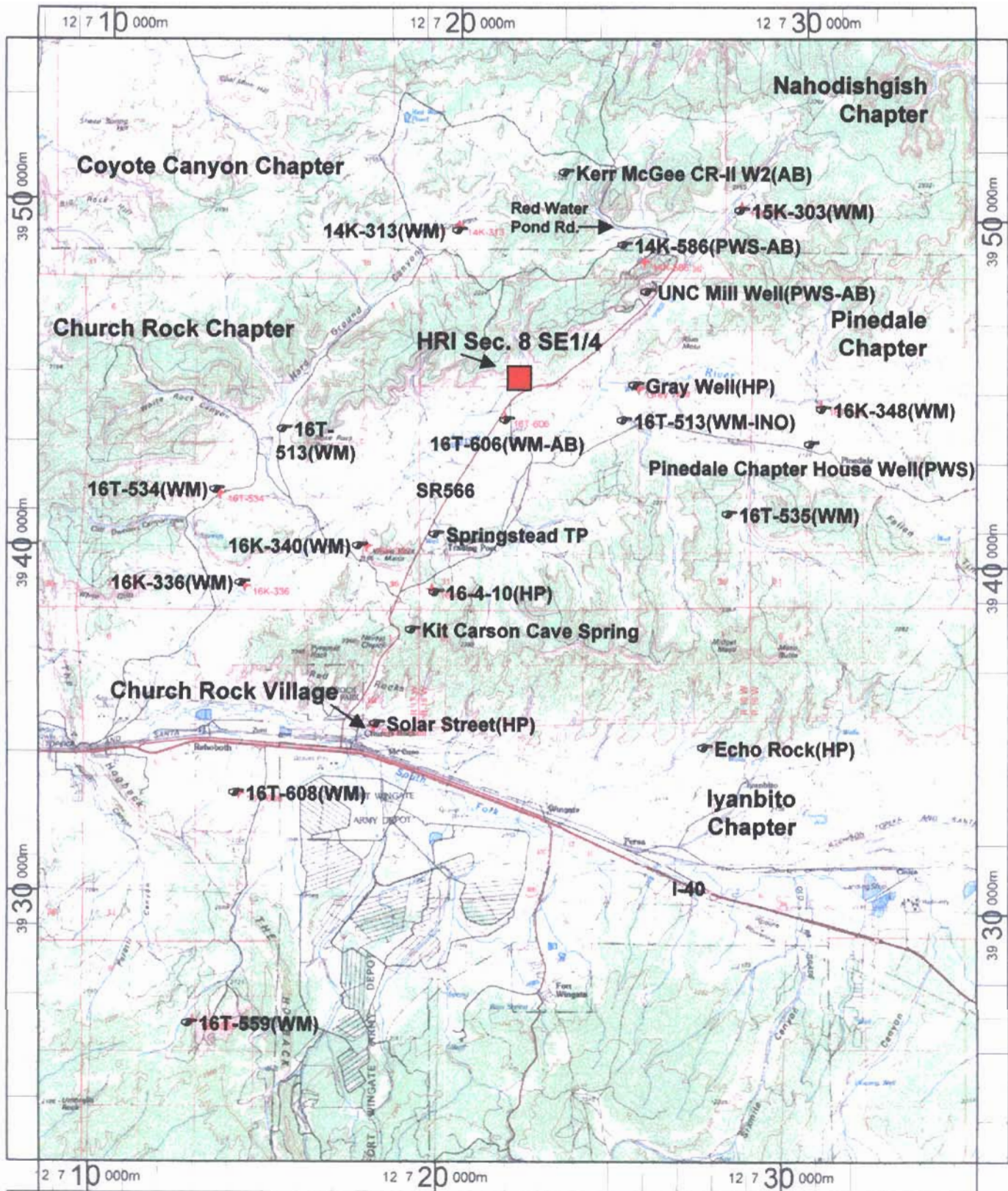

Name: GALLUP

Date: 2/24/2004

Scale: 1 inch equals 2.254 miles

Source: Navajo Dept. Water Resources; Rev'd by SRIC Jan. '06

Location: 12 721718 E 3938716 N

Caption: Church Rock Well Listing

AB = abandoned; HP = handpump; INO = inoperative on 1/1/06;

PWS = public water supply; TP = trading post; WM = windmill

Copyright (C) 1997, Maptech, Inc.

## Water Sources in Church Rock Chapter Area

EXHIBIT

12

tabbles

## Church Rock-area Water Sources

Updated 1/27/06

Navajo Well #	Well Name	Chapter	TRS Coordinates	Formation	Well Type	TD (ft.)	Use(s)	Status as of 1/1/06	Ownership
14K-313	Brown Bull	Coyote Canyon	17.16.32 or 29	Kg	drilled well, windmill	622	LS, DOM	operating	NavNation
14K-586	Friendship I	Coyote Canyon	17.16.35	Kmv or Kg	drilled well, sub-pump	750	CWS	abandoned	NavNation
15K-303	Pipeline Cyn.	Nahodishgish	17.15.29.421	Kg	drilled well, windmill	614	LS	operating	NavNation
16-4-10	Lime Ridge	Church Rock	16.16.31.33	Jmw?	dug well, hand pump	<10	LS, DOM	operational, not used	NavNation
16K-336	Puerco No. Fork	Church Rock	16.17.33.4223	Qal	drilled well, windmill	122	LS	operating	NavNation
16K-340	Windmill Cluster	Church Rock	16.17.25.1132	Qal	drilled well, windmill	141	LS	operating	NavNation
16T-348	Lobo Valley	Pinedale	16.15.17.1431	Kd	drilled well, windmill	410	LS	operating	NavNation
16T-510	Nose Rock	Church Rock	16.17.15.242	Kd	drilled well, windmill	680	LS, DOM	operating	NavNation
16T-513	Uphill Windmill	Pinedale	16.16.15.4322	Jmw	drilled well, windmill	318	LS, DOM	inoperative	NavNation
16T-534	Superman Canyon	Church Rock	16.17.21.344	Jmw	drilled well, windmill	410	DOM, LS	operating	NavNation
16T-559	Coal Mine/ Henry's	Church Rock	15.17.33.43	unknown	drilled well, windmill	unk	LS	operating	NavNation
16T-606	King Ranch	Church Rock	16.16.17.411	Kd	drilled well, windmill	417	LS	abandoned	NavNation
16T-608	Yazzie Family	Church Rock	15.17.21.4	unk	drilled well, windmill	unk	DOM, LS	operating	NavNation
none	Kerr-McGee CR-It-W2	Coyote Canyon	17.16.22.432	Jmw	drilled well	2,514	unknown	abandoned	private
none	Pinedale CH Well	Pinedale	16.15.17.4333	unknown	drilled well, sub-pump	unknown	DOM	operating	NavNation
none	Springstead TP	Church Rock	16.16.30.33	Jmw?	drilled well, sub-pump	500	DOM	inaccessible	private
none	UNC Mill Well	Pinedale	16.16.2.11	Jmw	drilled well, sub-pump	1450	DOM	abandoned	private
unknown	Annie Grey	Pinedale	16.16.14.1111	Qal	dug well, hand pump	8	LS, DOM	operating	NavNation
unknown	Echo Rock Well	Iyanbito	15.16.1 (inferred)	Trc?	dug well, hand pump	7	LS, DOM	operating	NavNation
unknown	Kit Carson Cave	Church Rock	15.17.1	unknown	developed spring	<10	DOM	inaccessible	private
unknown	Solar St.	Church Rock	15.17.13.1	Qal?	drilled well, hand pump	unknown	LS	inoperative	NavNation

## Abbreviations and Symbols:

TRS = Township, Range, Section

Formations: d = Dakota; g = Gallup; K = Cretaceous; J = Jurassic; mv = Mesa Verde; mw = Morrison Westwater; Qal = Quaternary alluvium; Trc = Triassic Clinle

TD = Total Depth of well, in feet; unk = unknown depth

Uses: CWS = community water supply; DOM = domestic; LS = livestock; PWS = public water supply;

List compiled by SRIC from field reconnaissance and records of Navajo Dept. of Water Resources, NM State Engineer Office, private companies