

US EPA ARCHIVE DOCUMENT

New England Association of Environmental Biologists
 34th Annual meeting, The Hotel Viking, Newport, RI
 March 17-19, 2010 Conference Summary

Start Time	Wednesday 3/17	Thursday 3/18	Friday 3/19
6:30 AM		Breakfast	Breakfast
8:00 AM		Registration	Registration
8:30 AM		Session 3A <i>Freshwater Invasive Species</i>	Session 6A <i>Streamflow & Thermal Regimes</i>
9:00 AM		Session 3B <i>Bioassessment & the BCG</i>	Session 6B <i>Nutrients</i>
9:30 AM		Session 3C <i>Outreach, Education & Communication</i>	Free Time <i>Taxonomy Workshop</i>
10:00 AM		AM Break 10:00 - 10:15	AM Break
10:30 AM		Plenary Session	Session 7A <i>Fish Assemblages & Distributions</i>
11:00 AM			Session 7B <i>TMDLs</i>
11:30 AM		Buffet Lunch	<i>Taxonomy Workshop</i>
12:00 PM	Registration		
1:00 PM	Session 1A <i>Mapping</i>	Session 4A <i>Lakes: Monitoring</i>	
	Session 1B <i>Wetlands & Amphibians</i>	Session 4B <i>Stream Biomonitoring I</i>	
	Session 1C <i>Critical Technical Elements I</i>	Session 4C <i>Estuaries & Coastal Resources</i>	
2:30 PM	PM Break	PM Break	
3:00 PM	Session 2A <i>Phragmites</i>	Session 5A <i>Lakes: Habitat & Bioassessment</i>	Session 5C <i>Dam Removal & Streamflow Restoration</i>
	Session 2B <i>Wetland Assessments</i>	Session 5B <i>Stream Biomonitoring II</i>	
	Session 2C <i>Critical Technical Elements II</i>	Free Time	Free Time
4:30 PM	Business Meeting		
5:00 PM		Poster Session	
5:30 PM	Dinner on your own		
6:30 PM		Dinner Banquet & Entertainment	
8:00 PM	Celebrate St. Patrick's Day in Downtown Newport	Social at One Bellevue	

- Salon A&B
- Salon C
- Salon D
- Salon E
- Colonnade Room
- Touro Room

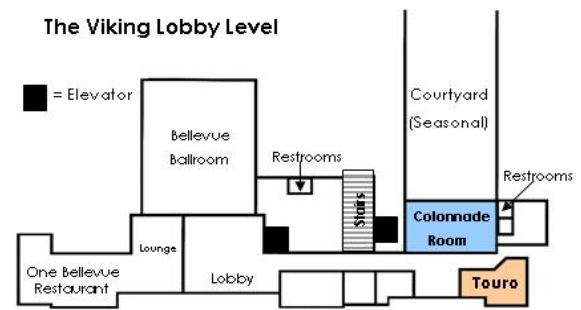
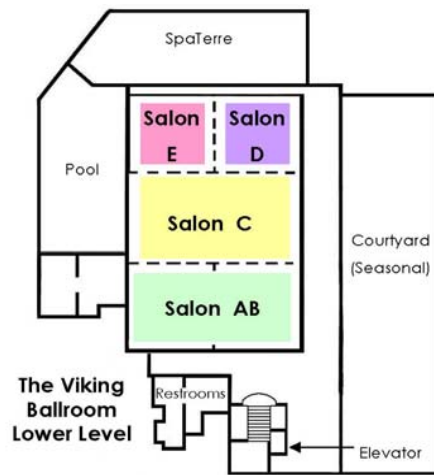

New England Association of Environmental Biologists
 34th Annual meeting, The Hotel Viking, Newport, RI
 Wednesday, March 17

Start Time			
12:00 PM	Registration (Salon AB)		
1:00 PM	Session 1A Colonnade Room Mapping	Session 1B Salon D Wetlands & Amphibians	Session 1C Salon E Critical Technical Elements I
1:00 PM	<i>Characterizing, Mapping and Applying Level IV Ecoregions in New England for Integrated Ecosystem Assessment and Management</i> - Greg Hellyer, USEPA	<i>Incidence of Batrachochytrium dendrobatidis in Rhode Island Anuran Populations</i> - Mandy Gaudreau, Antioch University New England	Critical Technical Elements of New England Bioassessment Programs Susan P. Davies, Midwest Biodiversity Institute Chris O. Yoder, Midwest Biodiversity Institute
1:30 PM	<i>New York Ecoregional Mapping</i> - Gregory J. Edinger, New York State Department of Environmental Conservation	<i>Vernal Pool Mapping</i> - RIDEM	
2:00 PM	<i>Hidden Waters: The Invisible Streams of Central Massachusetts</i> - Betsey Colburn, Harvard Forest	<i>Assessing Occupancy Estimates of Pond-breeding Amphibians in Rhode Island</i> - Peter Paton, University of Rhode Island	
2:30 PM	PM Break (Salon AB)		
3:00 PM	Session 2A Colonnade Room Phragmites	Session 2B Salon D Wetland Assessments	Session 2C Salon E Critical Technical Elements II
3:00 PM	<i>Phragmites australis in Coastal Marshes: Perspectives of a Successful Plant Invader</i> - Laura A. Meyerson, URI	<i>Wetlands Functional Analysis and Designated Use Assessment: The Same thing by Different Names?</i> - Paul Currier, New Hampshire Department of Environmental Services	Critical Technical Elements: The BCG and Tiered Aquatic Life Uses (TALU) Susan P. Davies, Midwest Biodiversity Institute Chris O. Yoder, Midwest Biodiversity Institute
3:30 PM	<i>Restoration of Tidally Restricted Salt Marshes at Rumney Marsh, Revere, Massachusetts: Balancing Flood Protection with Marsh Restoration by Use of Self-Regulating Tidegates</i> - Edward Reiner, USEPA	<i>Update on the National Wetland Condition Assessment: 2011</i>	
4:00 PM	<i>Phragmites Control and Restoration Projects</i> - Keith Gazaille, Aquatic Control Technology	<i>RIDEM Rapid Assessment Method</i> - Tom Kutcher, Rhode Island Natural History Survey	
4:30 PM	Business Meeting (Touro Room)		
5:30 PM	Dinner - on your own		
8:00 PM	 Celebrate St. Patrick's Day in Downtown Newport		

**New England Association of Environmental Biologists
34th Annual meeting, The Hotel Viking, Newport, RI
Thursday, March 18**

Start Time			
6:30 AM	Breakfast (Salon C)		
8:00 AM	Registration (Salon AB)		
8:30 AM	Session 3A Colonnade Room Freshwater Invasive Species	Session 3B Salon D Bioassessment & the BCG	Session 3C Salon E Outreach, Education & Communication
8:30 AM	<i>Invasives Species Monitoring: Approaches for Volunteer Programs</i> - Elizabeth Herron, URI Cooperative Extension	<i>The New England Biological Condition Gradient (BCG) Model</i> - Ben Jessup, Tetra Tech, Inc.	<i>Watershed Protection: Enlisting Public Participation Through Outreach</i> - Gina DeMarco, Northern Rhode Island Conservation District
9:00 AM	<i>The Ups and Downs of Winter Lake Drawdown as Part of a Long-term Invasive Weed Control Program in a Massachusetts Lake</i> - Matt Ladewig, ESS Group, Inc.	<i>Comparisons of Water Quality Ratings Derived from State and Federal Assessment Methods Versus those Derived from the Biological Condition Gradient (BCG)</i> - Jen Stamp, Tetra Tech, Inc.	<i>Working with Students, Macroinvertebrates and Kayaks</i> - Denise J. Poyer, Wood-Pawcatuck Watershed Association
9:30 AM	<i>Connecticut's Invasive Aquatic Plants: Search for Solutions</i> - Gregory J. Bugbee, The Connecticut Agricultural Experiment Station	<i>Bioassessment on the Delaware River: Challenges & Approaches for a Large River</i> - Erik L Silldorff, Delaware River Basin Commission	<i>Developing a Report Card of Assessed Waters in Connecticut</i> - Erik Bedan, Connecticut Department of Environmental Protection
10:00 AM	AM Break (Salon AB)		
10:15 AM	PLENARY TALKS		
	Salon D&E Curt Spalding, Regional Administrator, EPA Region 1 Mark P. Smith, Director, Eastern U.S. Freshwater Program, The Nature Conservancy		
11:30 AM	Buffet Lunch (C)		
1:00 PM	Session 4A Colonnade Room Lakes: Monitoring	Session 4B Salon D Stream Biomonitoring I	Session 4C Salon E Estuaries & Coastal Resources
1:00 PM	<i>Using EPA's National Lake Assessment to Assess the Condition of Vermont Lakes</i> - Mark Mitchell, Vermont Department of Environmental Conservation	<i>Application of the Index of Biotic Similarity (B) to the Analysis of the Data Generated by the Streams Project</i> - Carlos F. A. Pinkham, Norwich University	<i>A Changing World : A Changing Narragansett Bay?</i> - Chris Deacutis, Narragansett Bay Estuary Program
1:30 PM	<i>A Remote Sensing Approach to Measure Water Quality in New England Lakes: Where Are We Now and What's Next?</i> - Shane R Bradt, Sea Grant & Water Resources, UNH Cooperative Extension	<i>Life in a Conduit</i> - Rosemary Gatter-Evarts, Connecticut Department of Environmental Protection	<i>Inverse Demographic Analysis of Compensatory Response to Resource Limitation in the Marine Mysid <i>Americamysis bahia</i></i> - Jason Gear, USEPA Atlantic Ecology Division
2:00 PM	<i>Candlewood Lake Ice-In Ice-Out Report</i> - Alberto F. Mimo	<i>Distinguishing the Effects of Point Source from Those Caused by Upstream Nonpoint Source (NPS) Inputs: Refinement of a Watershed Development Index for New England</i> - Naomi E. Detenbeck, USEPA Atlantic Ecology Division	TBD
2:30 PM	PM Break (Salon AB)		
3:00 PM	Session 5A Colonnade Room Lakes: Habitat & Bioassessment	Session 5B Salon D Stream Biomonitoring II	Session 5C Salon E Dam Removal & Streamflow Restoration
3:00 PM	<i>Evaluation of the Lake Macroinvertebrate Integrity Index (LMII) and Alternate Indices for Eastern US Lakes and Reservoirs</i> - James Kurtenbach, USEPA Region 2	<i>Exploring Algal Community Dynamics Across Varying Enrichment Conditions Using GIS and Statistical Methods to Develop Holistic Nutrient Criteria in Connecticut Rivers and Streams</i> - Mary Becker, Connecticut Department of Environmental Protection	<i>Streamflow Management Alternatives for Aquatic Habitat and Herring Restoration in a Small Public Water Supply Reservoir System (First Herring Brook, Scituate MA)</i> - Margaret Kearns, Massachusetts Division of Ecological Restoration
3:30 PM	<i>Lentic Biomonitoring: Littoral Macroinvertebrate Community Response to Lakeshore Development</i> - Jeremy Deeds, Vermont Department of Environmental Conservation	<i>Stream Algal Model for Predicting Attainment of Maine Water Quality Classes</i> - Tom Danielson, Maine Department of Environmental Protection	<i>Halifax Dam Removal. What happens when the water goes down?</i> - Jennifer Burton-Reeve, Kleinschmidt Associates
4:00 PM	<i>How Much of a Buffer is Needed to Mitigate the Change to Littoral Habitat from Lakeshore Development?</i> - Kellie Merrell, Vermont Department of Environmental Conservation	<i>Periphyton Community Dynamics in Lake George Sub-Watersheds</i> Emily Porter-Goff, Rensselaer Polytechnic Institute	<i>Road Crossings and Potential Barriers to Fish and Wildlife Movement: Rhode Island River and Stream Continuity Project</i> - Chris Modisette, Rhode Natural Resources Conservation Service
4:30 PM	Free Time	<i>The Effects of Urban Development on Stream Ecosystems in the Northeastern Coastal Zone Ecoregion of New England</i> - James F. Coles, USGS	Free Time
5:00 PM	Poster Session (Colonnade Room)		
6:30 PM	Banquet Dinner & Entertainment Salon C		
8:00 PM	Social at One Bellevue Lounge		

New England Association of Environmental Biologists
 34th Annual meeting, The Hotel Viking, Newport, RI
 Friday, March 19

TIME			
6:30 AM	Breakfast (Salon C)		
8:00 AM	Registration (Salon AB)		
8:30 AM	Session 6A Salon D Streamflow & Thermal Regimes	Session 6B Salon E Nutrients	
8:30 AM	<i>Summer Water Temperatures in New Hampshire and Massachusetts Coldwater Streams</i> - Jennifer Jacobs, University of New Hampshire	<i>Use-perception Data in Wadeable Streams of New York State: Implications for Nutrient Criteria</i> - Alexander J. Smith, New York State Department of Environmental Conservation	
9:00 AM	<i>The Effects of Drought on Macroinvertebrates and Fish in Connecticut Streams</i> - Michelle Tipton, Wesleyan University	<i>New USGS Regional Water Quality Modeling in New England</i> - Keith Robinson, USGS	Taxonomy Workshop: EPT Forum Dr. Steven Burian Southern Connecticut State University Touro Room
9:30 AM	<i>Stream Depletion Method to Establish Ecological Flows for Groundwater Withdrawals in Rhode Island</i> - Alisa Richardson, Rhode Island Department of Environmental Management	<i>Denitrification Hotspots in Fluvial Systems: The Role of Woody Debris</i> - Julia Hyman, University of Rhode Island	
10:00 AM	AM Break (Salon AB)		
10:30 AM	Session 7A Salon D Fish Assemblages & Distribution	Session 7B Salon E TMDLs	Taxonomy Workshop: EPT Forum Dr. Steven Burian Southern Connecticut State University Touro Room
10:30 AM	<i>Pre-Columbian Freshwater Fish in Maine and New England</i> - Dave Halliwell, Maine Department of Environmental Protection	<i>So You Have an Impervious Cover TMDL, Now What?</i> - Chris Bellucci, Connecticut Department of Environmental Protection	
11:00 AM	<i>The New England Large River Fish Assemblage Assessment Project: Some Initial Findings and/or Fish Assemblage Assessment of the Connecticut River Mainstem, 2008-9</i> - Chris O. Yoder Midwest Biodiversity Institute	<i>Development of a Volunteer Based Chloride TMDL in the Hodgson Brook Watershed</i> - Ted Walsh, New Hampshire Department of Environmental Services	
11:30 AM	<i>Developing and Testing Refinements for a Fish Assemblage Assessment Index for Large Rivers in Maine: How to Incorporate Diadromous Species</i> - Chris O. Yoder Midwest Biodiversity Institute	<i>T-RFLP for the Bacterial Source Tracking of Escherichia coli from Feral Pigeons and Cattle in Agricultural Roof-Runoff</i> - Michael J. Turner, University of Connecticut	