

US EPA ARCHIVE DOCUMENT

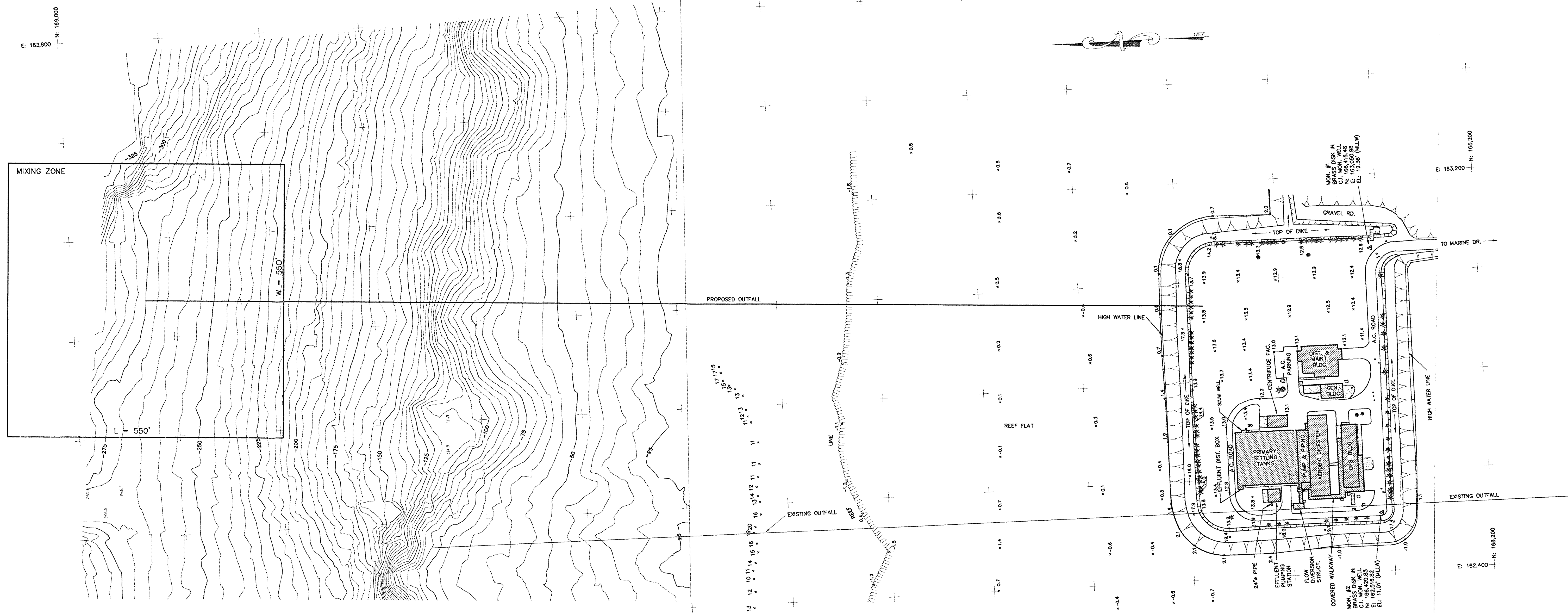

HDD OUTFALL PLAN
HOR. 1" = 100'

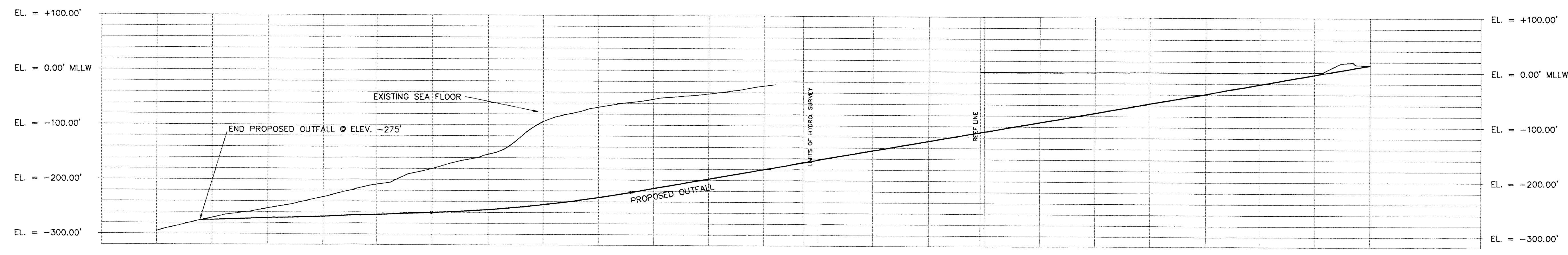

HDD OUTFALL PROFILE
HOR. 1" = 100'
VER. 1" = 100'

LOCATION MAP
NTS

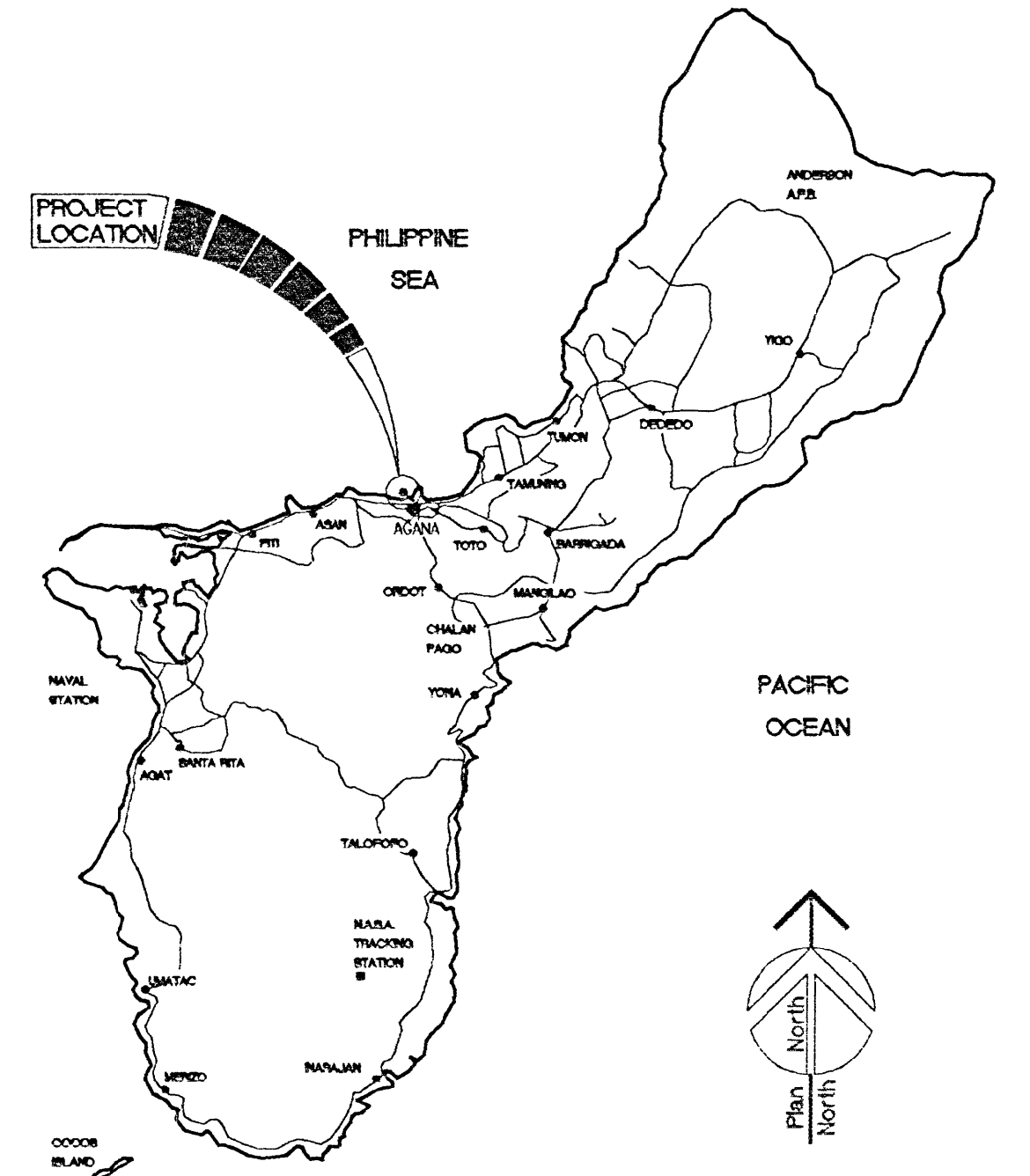

GUAM-USA

SURVEYOR'S NOTES

1. SURVEY WAS BASED ON THE FOLLOWING GGN-93 POINTS CONVERTED TO GGN-63 VALUES:
GGN 1460 N 165,329.53 E 161,853.06
GGN 1464 N 165,570.73 N 164,188.55
GGN 1466 N 166,386.91 E 164,634.56
MON. #2 ELEV. 11.01 (MLLW)
2. CONTOURS ARE BASED ON MEAN LOWER LOW WATER (MLLW)
3. CONTOUR INTERVAL IS 1' INSIDE REEF LINE AND 5' OUTWARDS
4. SURVEY DATA RECORDED IN FIELDBOOK G99-01

BATHYMETRY NOTES

1. DEPTHS ARE PROVIDED IN FEET - DATUM IS MEAN LOWER LOW WATER (MLLW)
2. HORIZONTAL DATA ARE PROVIDED IN PLANE COORDINATES USING THE FOLLOWING GEODETIC PARAMETERS:
SPHEROID : CLARK 1866
DATUM : GUAM 1963
PROJECTION : AZIMUTHAL EQUIDISTANT
3. BATHYMETRY DATA OBTAINED ON NOVEMBER 11, 1998 USING A KNUDSEN 3208/P ECHOSOUNDER WITH 200 kHz TRANSDUCER
4. SURFACE POSITIONING OBTAINED USING ASHTECH DNS-12 DGPS

REVISION	DATE	BY	DESCRIPTION	APPROVED
PROJECT No. _____				
GUAM WATERWORKS AUTHORITY GOVERNMENT OF GUAM				
TUMON INFRASTRUCTURE AND BEAUTIFICATION AGAÑA STP OUTFALL EXTENSION HORIZONTAL DIRECTIONAL DRILLING PLAN AND PROFILE				
CONTRACT No.	DESIGNED BY: _____			
DRAWN BY: _____	CHECKED BY: _____			
SUPV. BY: _____	RECOMMENDED BY: _____			
PROJECT ENGINEER	CHIEF OF ENGINEERING			DATE
SECTION MANAGER	ASSOCIATES, INC. ENGINEERS/ARCHITECTS 2077 NORTH WALKERS BLDG. TAKAPOW, GUAM 96931 TEL: 647-4477 FAX: 647-1487			DRAWING NUMBER
SCALE: AS NOTED	EDWARD K. NODA & ASSOCIATES, INC. 915 PINK ST. #400 MARIETTA, GEORGIA 30064			SHEET OF