

US EPA ARCHIVE DOCUMENT

RCRA FACILITY INVESTIGATION

PHASE II REPORT FIGURES

GENERAL MOTORS CORPORATION NAO FLINT OPERATIONS SITE FLINT, MICHIGAN

JULY 14, 2006

PREPARED FOR:



General Motors Corporation Remediation Team
Worldwide Facilities Group

PREPARED BY:



INDEX TO FIGURES

- 2-1 SITE LOCATION MAP (COVER SHEET)
- 2-2 SITE PLAN - NORTHEND
- 2-3 SITE PLAN - SOUTHEND
- 2-4 INTERIM MEASURE AND STORM SEWER LOCATION MAP - NORTHEND
- 2-5 INTERIM MEASURE AND STORM SEWER LOCATION MAP - SOUTHEND
- 3-1 GROUNDWATER ELEVATION CONTOUR MAP - JUNE 2002
- 3-2 GROUNDWATER ELEVATION CONTOUR MAP - MARCH 2003
- 3-3 GROUNDWATER ELEVATION CONTOUR MAP - NORTHEND - DECEMBER 2004
- 3-4 GROUNDWATER ELEVATION CONTOUR MAP - SOUTHEND - DECEMBER 2004
- 3-5 ZONING MAP
- 4-1 SOIL ANALYTICAL DATA - BUILDING 38 AREA
- 4-2 GROUNDWATER ANALYTICAL DATA - BUILDING 38 AREA
- 4-3 SOIL ANALYTICAL DATA - BUILDING 36 AREA
- 4-4 GROUNDWATER ANALYTICAL DATA - BUILDING 36 AREA
- 4-5 SOIL ANALYTICAL DATA - BUILDING 20 AREA
- 4-6 GROUNDWATER ANALYTICAL DATA - BUILDING 20 AREA
- 4-7 SOIL ANALYTICAL DATA - FACTORY 05 (BUILDING 43) AREA
- 4-8 GROUNDWATER ANALYTICAL DATA - FACTORY 05 (BUILDING 43) AREA
- 4-9 SOIL ANALYTICAL DATA - BUILDING 30 AREA
- 4-10 GROUNDWATER ANALYTICAL DATA - BUILDING 30 AREA
- 4-11 SOIL ANALYTICAL DATA - FACTORY 81 (BUILDINGS 69, 70, 71, 72, 73, AND 74) AREA
- 4-12 GROUNDWATER ANALYTICAL DATA - FACTORY 81 (BUILDINGS 69, 70, 71, 72, 73, AND 74) AREA
- 4-13 SOIL ANALYTICAL DATA - BUILDINGS 07, 21, 85, AND 86 AREA
- 4-14 GROUNDWATER ANALYTICAL DATA - BUILDINGS 07, 21, 85, AND 86 AREA
- 4-15 SOIL ANALYTICAL DATA - FACTORY 83/84 (BUILDINGS 11, 32, 65, 66, AND 83) AREA
- 4-16 GROUNDWATER ANALYTICAL DATA - FACTORY 83/84 (BUILDINGS 11, 32, 65, 66, AND 83) AREA
- 4-17 SOIL ANALYTICAL DATA - FORMER BUILDINGS 03, 17, 28, 84, AND 94 AREA
- 4-18 GROUNDWATER ANALYTICAL DATA - FORMER BUILDINGS 03, 17, 28, 84, AND 94 AREA
- 4-19 SOIL ANALYTICAL DATA - FORMER BUILDINGS 02, 12, 23, AND 29 AREA
- 4-20 GROUNDWATER ANALYTICAL DATA - FORMER BUILDINGS 02, 12, 23, AND 29 AREA
- 4-21 SOIL ANALYTICAL DATA - FORMER BUILDINGS 04, 08, 16, 40, AND 44 AREA
- 4-22 GROUNDWATER ANALYTICAL DATA - FORMER BUILDINGS 04, 08, 16, 40, AND 44 AREA
- 4-23 SOIL ANALYTICAL DATA - FORMER BUILDING 09 AREA
- 4-24 GROUNDWATER ANALYTICAL DATA - FORMER BUILDING 09 AREA
- 4-25 SOIL ANALYTICAL DATA - BUILDING 01 AREA
- 4-26 GROUNDWATER ANALYTICAL DATA - BUILDING 01 AREA
- 4-27 SOIL ANALYTICAL DATA - FORMER AERATION LAGOON AREA
- 4-28 GROUNDWATER ANALYTICAL DATA - FORMER AERATION LAGOON AREA
- 5-1 DISTRIBUTION OF CONSTITUENTS IN GROUNDWATER AT CONCENTRATIONS ABOVE GENERIC MDEQ CRITERIA - NORTHEND
- 5-2 DISTRIBUTION OF CONSTITUENTS IN GROUNDWATER AT CONCENTRATIONS ABOVE GENERIC MDEQ CRITERIA - SOUTHEND
- 5-3 ISOCONCENTRATION MAP OF SELECT CHLORINATED CONSTITUENTS IN GROUNDWATER - NORTHEND
- 5-4 ISOCONCENTRATION MAP OF SELECT CHLORINATED CONSTITUENTS IN GROUNDWATER - SOUTHEND
- 5-5 ISOCONCENTRATION MAP OF BENZENE, TOLUENE AND ETHYLBENZENE IN GROUNDWATER - NORTHEND
- 5-6 ISOCONCENTRATION MAP OF BENZENE IN GROUNDWATER - SOUTHEND

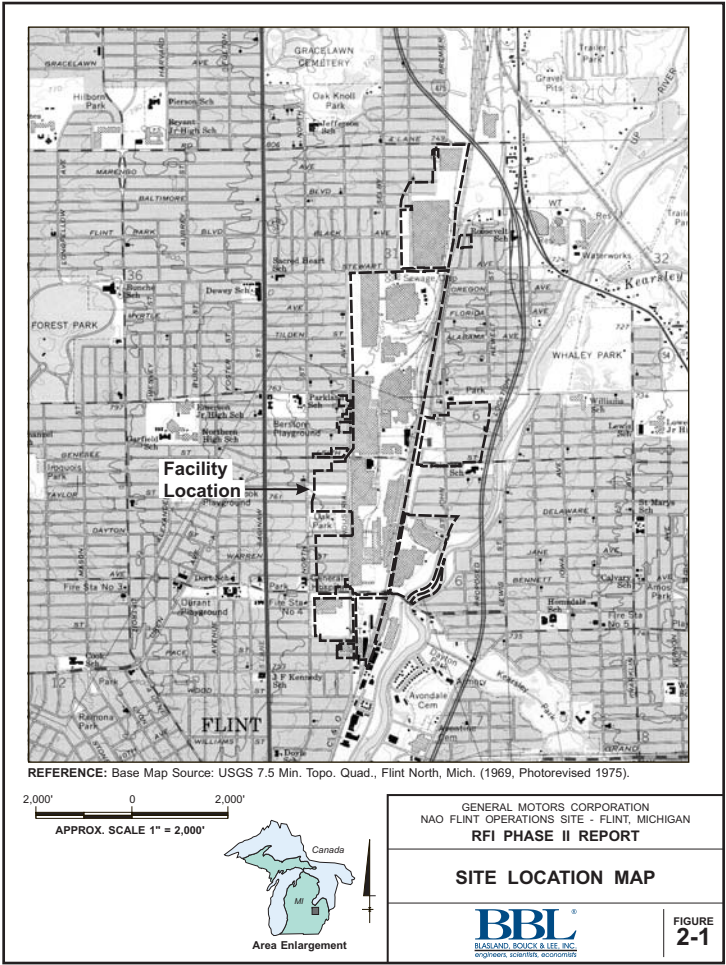

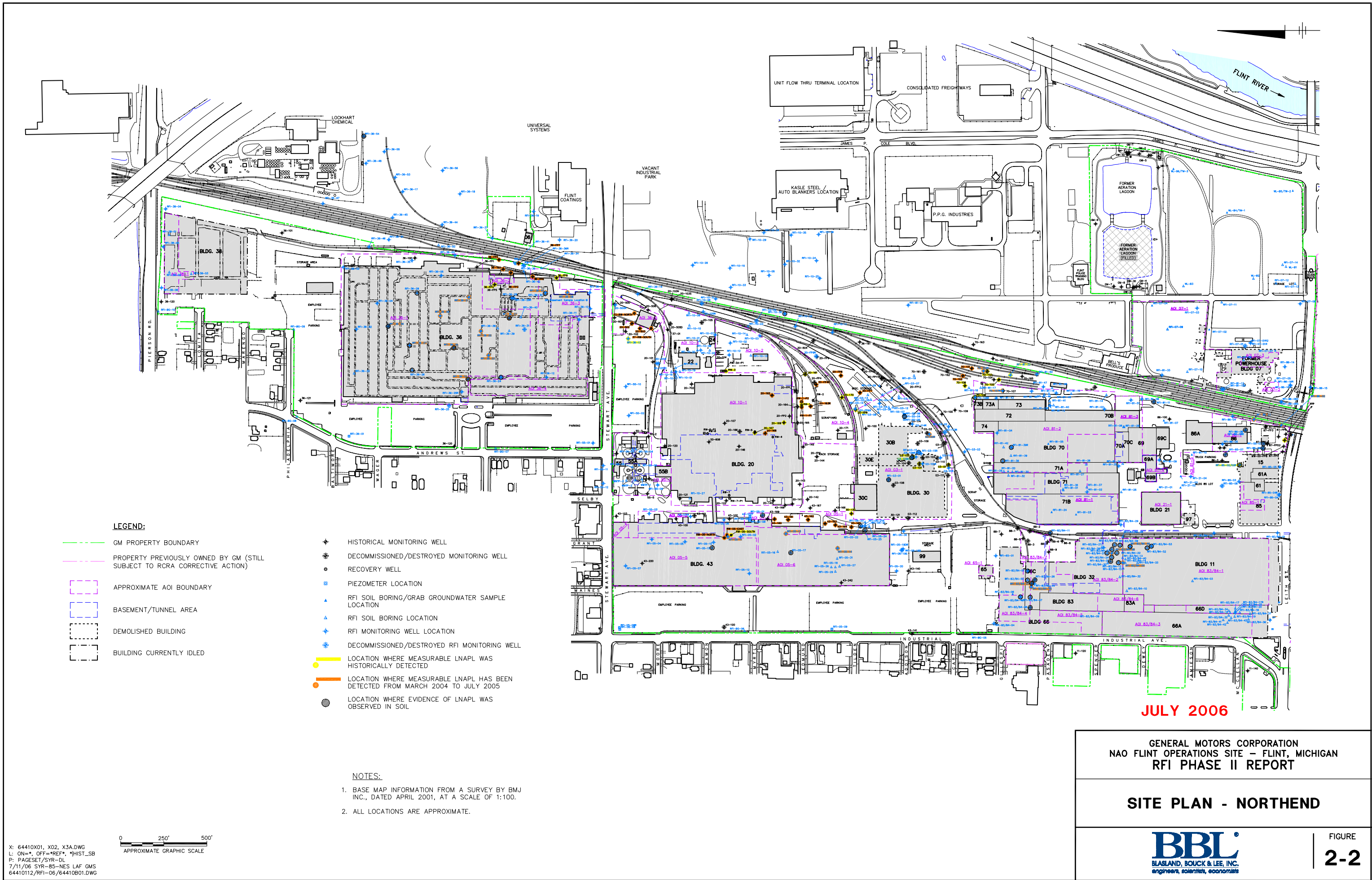

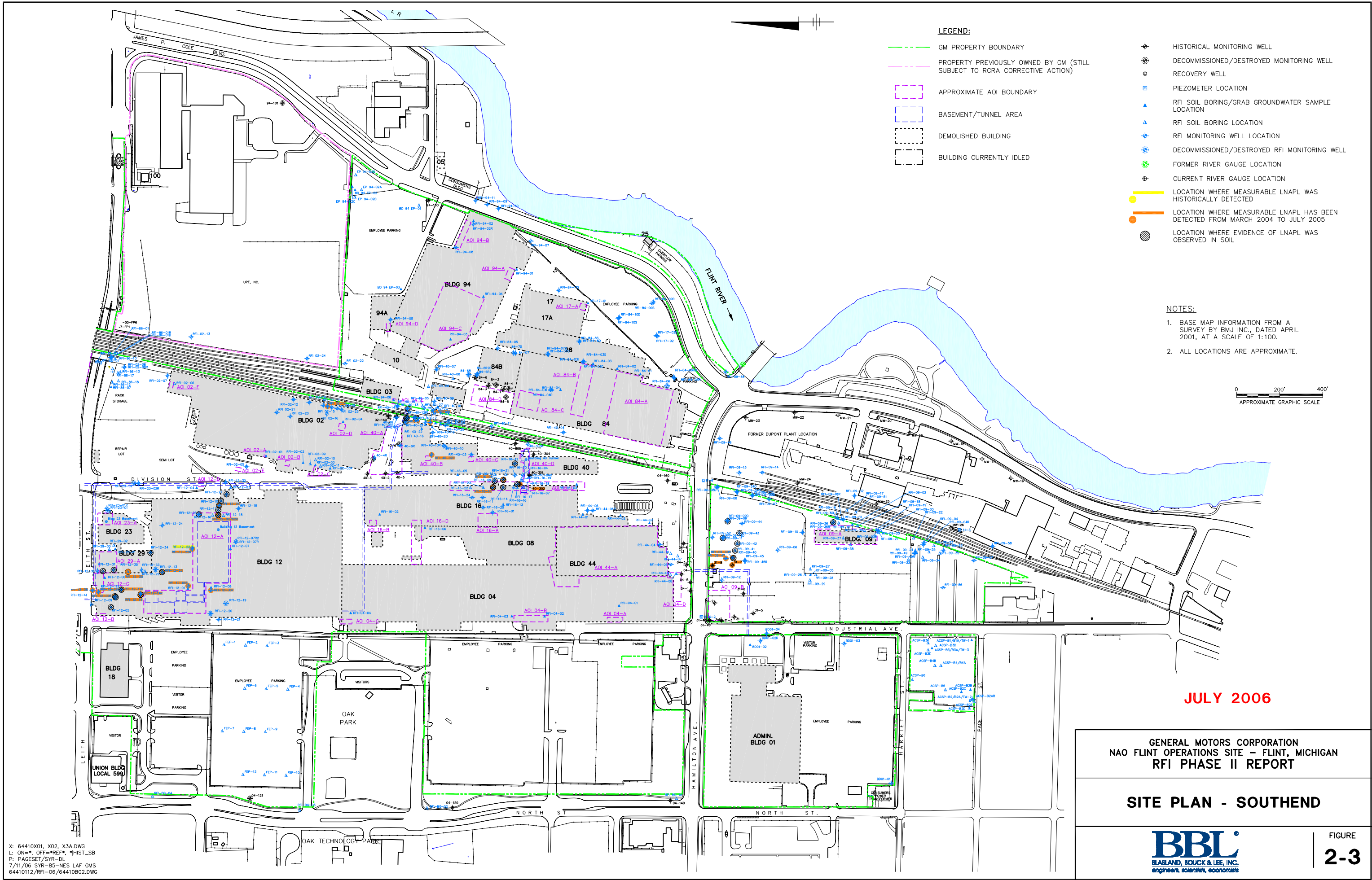

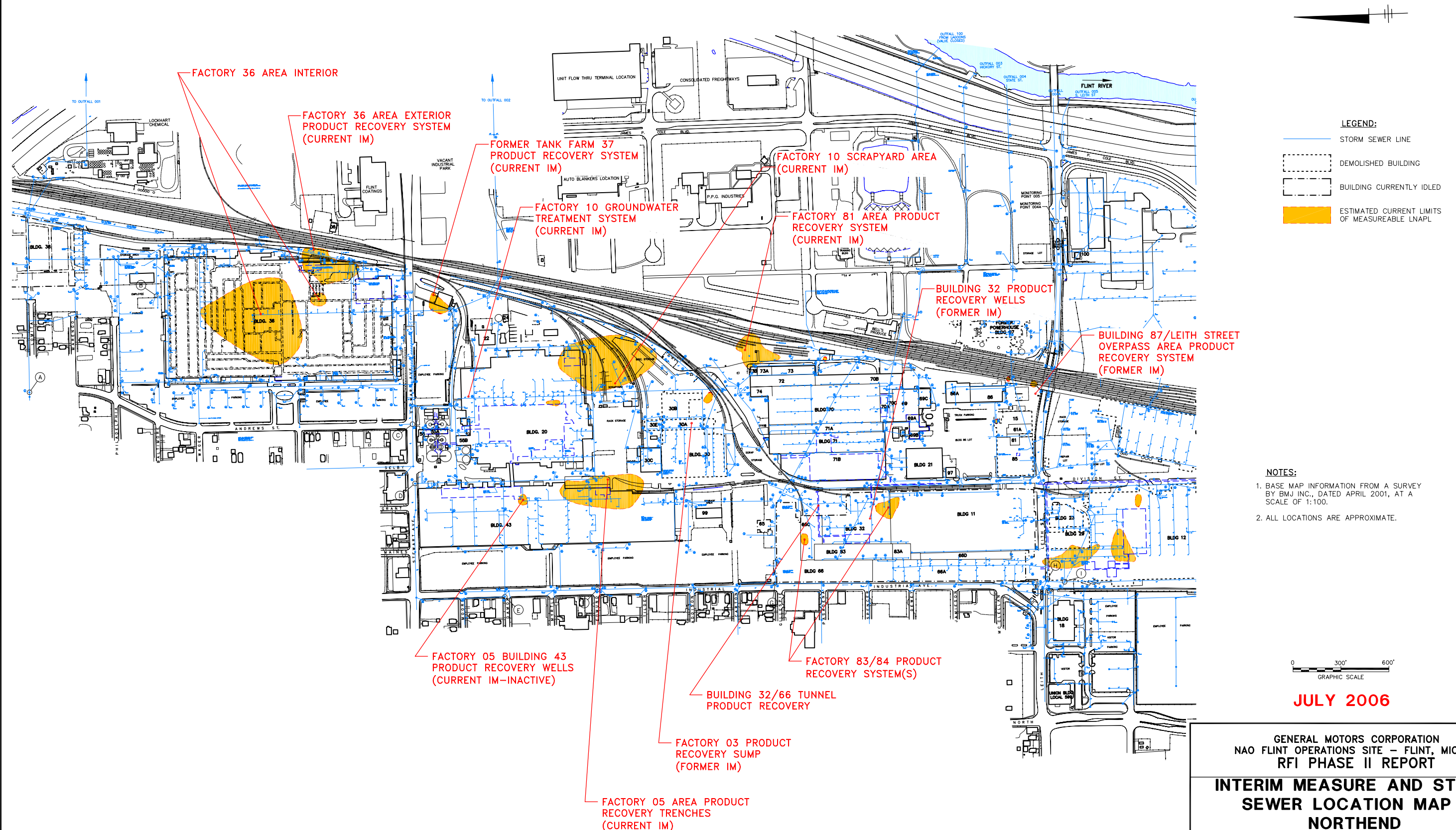



LEGEND:

- STORM SEWER LINE
- DEMOLISHED BUILDING
- BUILDING CURRENTLY IDLED
- ESTIMATED CURRENT LIMITS OF MEASUREABLE LNAPL

NOTES:

- BASE MAP INFORMATION FROM A SURVEY BY BMJ INC., DATED APRIL 2001, AT A SCALE OF 1:100.
- ALL LOCATIONS ARE APPROXIMATE.

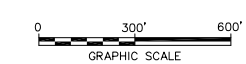

JULY 2006

GENERAL MOTORS CORPORATION
NAO FLINT OPERATIONS SITE - FLINT, MICHIGAN
RFI PHASE II REPORT

INTERIM MEASURE AND STORM
SEWER LOCATION MAP -
SOUTHEND



FIGURE
2-5

